



OUTDOORSINES

BE THE DESTINATION

32 Gallon Tapered Downtown Trash Receptacle with and Accessories



Downtown Trash Receptacle Models:

RDW32-I-01-000
RDW32-H-01-000
RDW32-G-01-000



Parts, Hardware, and Suggested Tools

Unit Common Description	Units Per Model
Downtown Tapered Trash Receptacle	1
Downtown Flattop	1
5/16-18 x 1 1/2" tap bolt w/black xylan	2
5/16-18 nylock nut w/black xylan	2
5/16 uss flat washer w/black ox	4
#vc300-8 5/16" bolt size 1/2" lg vinyl cap	2
Security Cable	1

Downtown Tapered Trash Receptacle



-  Bolt (HW01)
-  Nut (HW02)
-  Washer (HW03)
-  Bolt Cap (HW04)

All Mounting Accessories are sold seperately

Unit Common Description	Units Per Model
Inground Mount or Surface Mount	1
5/16-18 x 1 1/2" tap bolt w/black xylan	4
5/16-18 nylock nut w/black xylan	4
5/16 uss flat washer w/black ox	8
#vc300-8 5/16" bolt size 1/2" lg vinyl cap	4

Suggested Tools

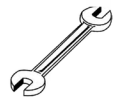

Open Face Wrench



Socket Wrench



Liner



Inground Mount



Surface Mount

Specification - Written

Trash Receptacle Material: Outer frame is made from 3/4" x 2" rolled form angle iron.

- Slatted Steel - Inside material is 11 gauge Slatted Steel. Bracing is 1-1/2" Solid Steel flat bar. All MIG welded.

Trash Receptacle Coating:

- Advantage Coating - MyTCoat's Advantage Coating is our proprietary coating unique only to MyTCoat. This state-of-the art coating will not chip, crack or peel. It doesn't have any drips or runs, and it the most durable coating on the market. The Advantage coating come with a 7 year Warranty and is available in 13 Different Colors.
- Industry Standard Coating - the Industry Standard line is coated with a Premium Polyethylene Coating, The Industry Standard coating comes with a 5 year warranty and is available in 9 different colors
- Powder Coat Finish - Premium High Quality Powder Coat Finish Electrostaticlly Applied with 13 Different Colors to choose from.

Flattop: 11 gauge Solid Formed Steel. Advantage Coating, Industry Standard Coating, or Powder Coat Finish

Hardware: All hardware is Xylan coating black hardware for extra protection and strength

Dimension: 32 Gallon Trash Receptacle Overall Dimension: 36" H, 27" Diametor

Specification - Drawing

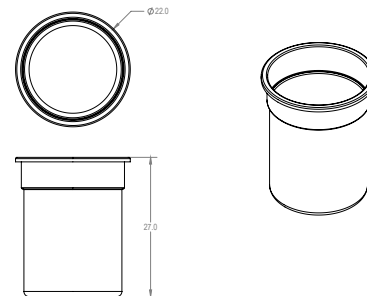
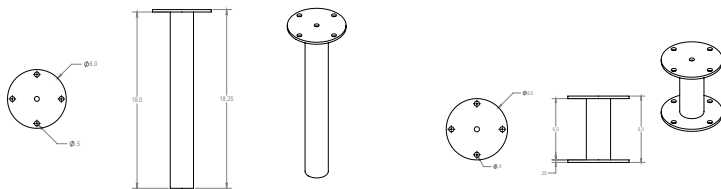
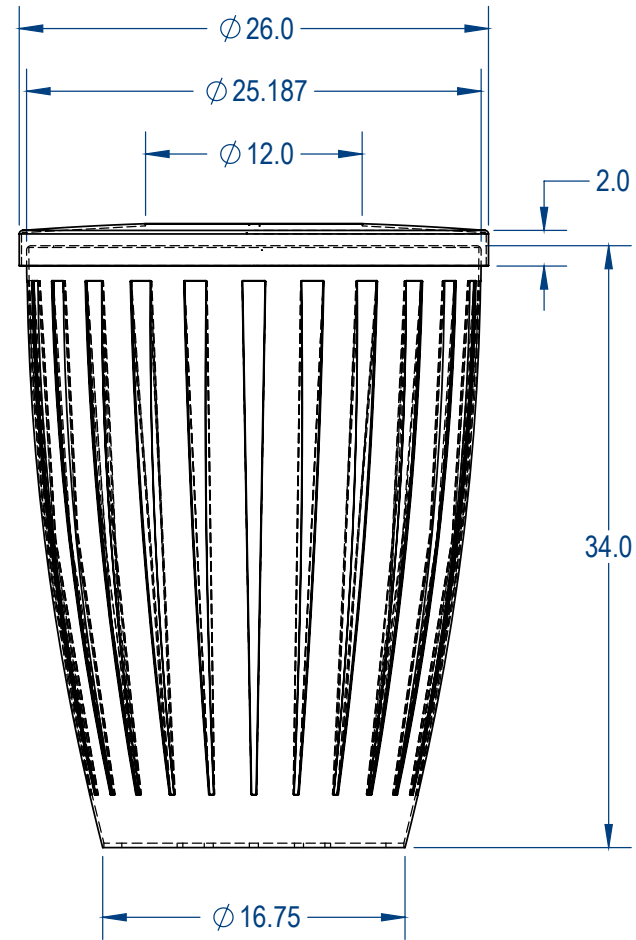
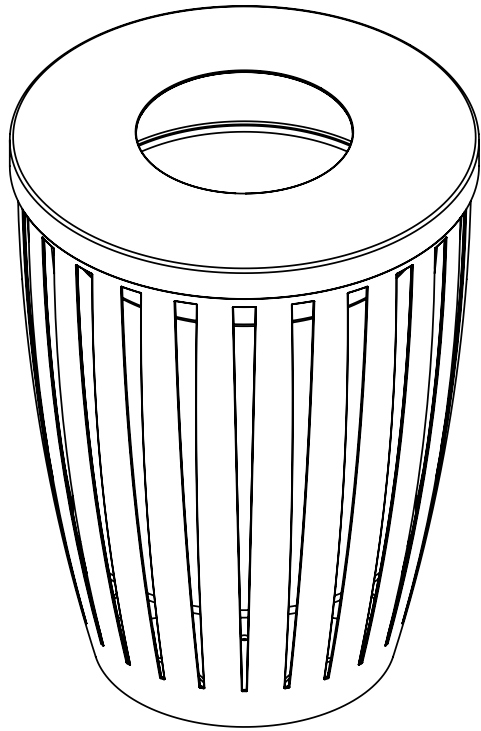

Assembly Instructions

- 1. Trash Receptacle Comes in One Piece**
- 2. Attached Security Cable at one in to the top using hardware provided and a pre-drilled bolt hole on the top.**
- 3. Attach the other end of the security cable to the Trash Receptacle using either the expanded metal or punched steel and the hardware provided. Leave enough slack in the cable to be able to remove the lid.**
- 4. If Inground Mount or Surface Mount is ordered: Attach Mounting by lining up the bolt hole pattern on the mount to the bolt hole pattern on the bottom of the Trash Receptacle and bolt together by using hardware provided.**
- 5. Liner is one piece. Place Liner in Trash Receptacle. The Top of the liner will rest on the lip of the Trash Receptacle.**

MyTCoat does not offer installation: Recommend a professional Installer to install bench inground

Installation Safety:

Please Follow Installation Instructions provided by Manufacturer

It is recommended that Product is installed by an experienced installer

Product should be inspected at the time of Delivery, do not install and damaged on defective parts or products.

All Hardware for proper assembly (not installation) is provided. Use hardware that is included with this product.

Product Maintenance:

Maintenance inspection should be performed at a minimum of once a year.

Cleaning, when necessary can be performed with warm water and most household cleaners, avoid any harsh chemicals such as paint remover and acetone. Contact Manufacturer before cleaning to determine if cleaning product is OK for use.

Any surface rust that may occur should be removed and repainted. Contact Manufacturer for touch up paint or any other recommended paints.

Contact Manufacturer for instructions on removing vandalism such as spray paint.

In the case that the MyTCoat coating is damaged, contact Manufacturer for instructions for repair.

Bolts and nuts should be checked on a regular basis to maintain proper tightness.